

SUBMITTAL DATA SHEET

| | |
|------------------------|---|
| JOB NAME: _____ | DATE: _____ |
| LOCATION: _____ |  |
| ENGINEER: _____ | |
| WHOLESALER: _____ | |
| CONTRACTOR: _____ | |
| SUBMITTED TO: m, _____ | |
| n _____ | FUEL: _____ |

CHECK ONE: _____ REFERENCE (NOT FOR PRODUCTION)
 _____ APPROVED (IMMEDIATE PRODUCTION)
 _____ APPROVED WITH CHANGES NOTED (IMMEDIATE PRODUCTION)

| RATINGS AND TECHNICAL DATA | | | | | | | |
|----------------------------|-------|--------|------------|---------|---------|-----------------------------|----------|
| EVOLUTION EVOW Models | INPUT | GROSS | THERMAL | HEATING | WATER | *FUEL | SHIPPING |
| | | OUTPUT | EFFICIENCY | SURFACE | CONTENT | NAT. GAS / LP Gas | WEIGHT |
| | (MBH) | (MBH) | (%) | (SQ/FT) | (GAL.) | MIN / MAX | (LBS) |
| EVOW-750 | 750 | 660 | 88.0% | 131 | 15.9 | 7"-14" wc (NG); 8"-14" (LP) | 1097 |
| EVOW-1000 | 1000 | 880 | 88.0% | 175 | 16.4 | 7"-14" wc (NG); 8"-14" (LP) | 1185 |
| EVOW-1500 | 1500 | 1320 | 88.0% | 264 | 17.4 | 7"-14" wc (NG); 8"-14" (LP) | 1327 |
| EVOW-2000 | 2000 | 1760 | 88.0% | 352 | 18.5 | 9"-14" wc | 1461 |

DIMENSIONS

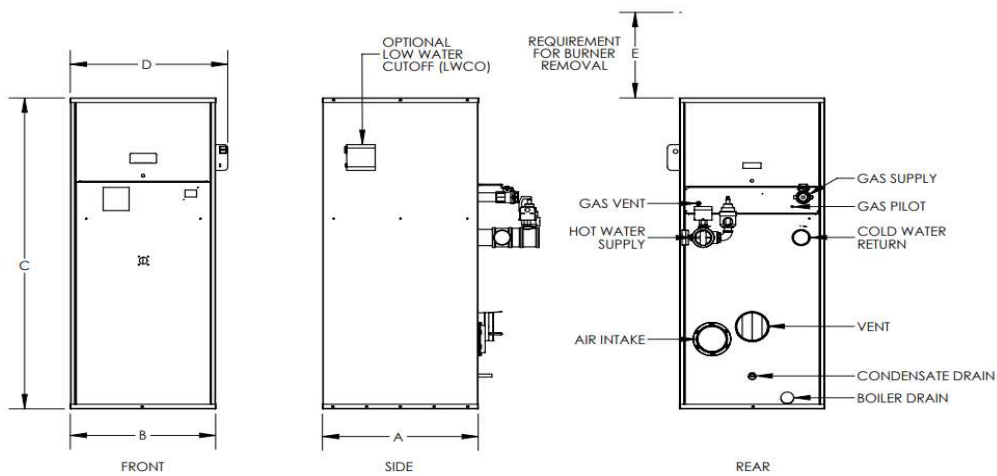

| EVOW Models | "A" | "B" | "C" | "D" | "E" | VENT / AIR INTAKE | | GAS | SUPPLY | RETURN |
|------------------|----------|----------|----------|-----------|----------------|-------------------|------------|----------|----------|--------|
| | LENGTH | WIDTH | HEIGHT | WIDTH | BURNER REMOVAL | VENT | AIR INTAKE | | OUTLET | INLET |
| | (Inches) | (Inches) | (Inches) | (w/ LWCO) | (Inches) | (Inches) | (Inches) | (Inches) | NPT Male | NPT |
| EVOW-750 | 30 1/4 | 28 1/4 | 61 | 31 | 16 | 4 | 6 | 1 1/2 | 3 | 3 |
| EVOW-1000 | 30 1/4 | 28 1/4 | 67 1/8 | 31 | 16 | 6 | 6 | 1 1/2 | 3 | 3 |
| EVOW-1500 | 30 1/4 | 28 1/4 | 79 1/8 | 31 | 19 | 6 | 8 | 1 1/2 | 3 | 3 |
| EVOW-2000 | 30 1/4 | 28 1/4 | 91 3/4 | 31 | 31 | 6 | 8 | 1 1/2 | 3 | 3 |

* Features Double Row of Copper Fin Tubes!

SUBMITTAL DATA SHEET

STANDARD EQUIPMENT

PRESSURE VESSEL DESIGN

Copper Fin-tube construction
 Carbon steel or cast iron header design
 Gasketless heat exchanger
 ASME Section IV certified "H" stamp
 MAWP 160 PSI & max design temp 250°F
 5-year heat exchanger warranty
 20-year thermal shock warranty

BOILER EQUIPMENT

Siemens RWF55 operating control
 High limit w/ manual reset safety temperature control
 Water flow switch
 Low water cut-off with manual reset safety controller
 Outlet temperature sensor
 Combustion air switch
 Pressure and temperature gauge
 Safety relief valve (optional pressures 30-150 PSI)
 Single point electrical supply (Available in 1 or 3 phase; See below for details).

COMBUSTION DESIGN

Maintenance-free ceramic burner
 Ultra-low NOx emissions (<10ppm)
 Whisper quiet operation (<50 dBA)
 Industrial-grade combustion air filter, 99% efficient
 Industrial cast aluminum blower assembly
 Variable frequency drive
 Electric spark-to-pilot ignition system
 10-year burner warranty
 Robust UV-Scanner

BURNER EQUIPMENT

UL/FM/CSD-1 gas train
 Reliable Turndown
 Natural or LP gas
 Pilot gas valve / Pilot gas regulator
 Siemens SKP-75 gas valve
 Low and high gas pressure switches with manual reset

VENTING

Sealed or room air combustion
 Direct vent (sidewall or vertical) (Cat IV)
 Conventional venting (Cat II)
 NOTE: This is NOT a Cat I Vent appliance.

SIEMENS RWF55 OPERATING CONTROL FEATURES

Adjustable set point
 Remote set point (0-10v or 4-20 mA)
 Outdoor air temperature reset
 Remote system temperature monitoring

OPTIONAL EQUIPMENT

- Low gas pressure venturi, allows operation down to 4" wc (Available on Models 750-2000 Only)
- Double block & bleed (DB&B) Gas Train - (1) motorized & (1) solenoid valve & N.O. vent valve
- IRI with Proof of Closure Gas Train - (2) motorized valves w/ POC & N.O. vent valve
- Honeywell 7800 Series display with ModBus Module
- Line Reactor Adds voltage / spike protection for the blower's VFD. (*Highly recommended.*)
- Electrical Power Supply:

| | | |
|--|-----------------------------------|-----------------------------------|
| <input type="checkbox"/> 120/60/1 (<i>Sizes 500-2000 ONLY</i>) | <input type="checkbox"/> 208/60/1 | <input type="checkbox"/> 230/60/1 |
| <input type="checkbox"/> 208/60/3 | <input type="checkbox"/> 230/60/3 | <input type="checkbox"/> 460/60/3 |
- Safety Relief Valve Options:

| | | | |
|----------------------------------|----------------------------------|----------------------------------|---------------------------------|
| <input type="checkbox"/> 30 PSI | <input type="checkbox"/> 50 PSI | <input type="checkbox"/> 60 PSI | <input type="checkbox"/> 75 PSI |
| <input type="checkbox"/> 100 PSI | <input type="checkbox"/> 125 PSI | <input type="checkbox"/> 150 PSI | |
- Outdoor Air Sensor
- Condensate neutralizer:

| | | | |
|----------------------------------|------------------------------------|------------------------------------|------------------------------------|
| <input type="checkbox"/> 850 MBH | <input type="checkbox"/> 1,200 MBH | <input type="checkbox"/> 2,000 MBH | <input type="checkbox"/> 5,000 MBH |
|----------------------------------|------------------------------------|------------------------------------|------------------------------------|
- Hydronic Kit (Boiler Circulation Pump, Pump Flange Kit and Condensate Neutralizer) Sized based on a 20°F ΔT
- Annual Maintenance Kit
- Supply system temperature sensor
- ModBus communication for Siemens RWF55 and Honeywell Flame Safeguard Control (Boiler to BMS System)
- Universal communications gateway (BacNet MS/TP, BacNet/IP, LonWorks)
- Local / remote switch
- Alarm bell with silencing switch
- Relays:

| | |
|--|--|
| <input type="checkbox"/> General Alarm | <input type="checkbox"/> Boiler Status |
|--|--|
- Conductor Sequencing Panel: (Required for multiple EVA boiler applications without BMS); Contact Regional Manager with Questions.)
 The Conductor manages multiple condensing & non-condensing, small & large heat output, new and/or existing boilers (full modulation or on-off), and steam or hot water applications. It helps improve system efficiency by selecting and modulating the right boiler to match operating conditions. The Conductor offers a single point boiler plant Energy Management System (EMS) interface including Modbus TCP/IP, Modbus RTU RS485, BACnet/IP and BACnet MSTP standard. If Lonworks needed, add for the separate Lonworks gateway.
- Extended Warranty:

| | | |
|---------------------------------------|---|--|
| <input type="checkbox"/> 3 Year Parts | <input type="checkbox"/> 5 Year Parts | <input type="checkbox"/> 10-Year Parts |
| | <input type="checkbox"/> 5-Yr. Prts/Lbr | <input type="checkbox"/> 10 Yr. Prts/Lbr |